

G ELECTRICAL WIRING ROUTING

Position of Parts in Engine Compartment

[5VZ-FE]

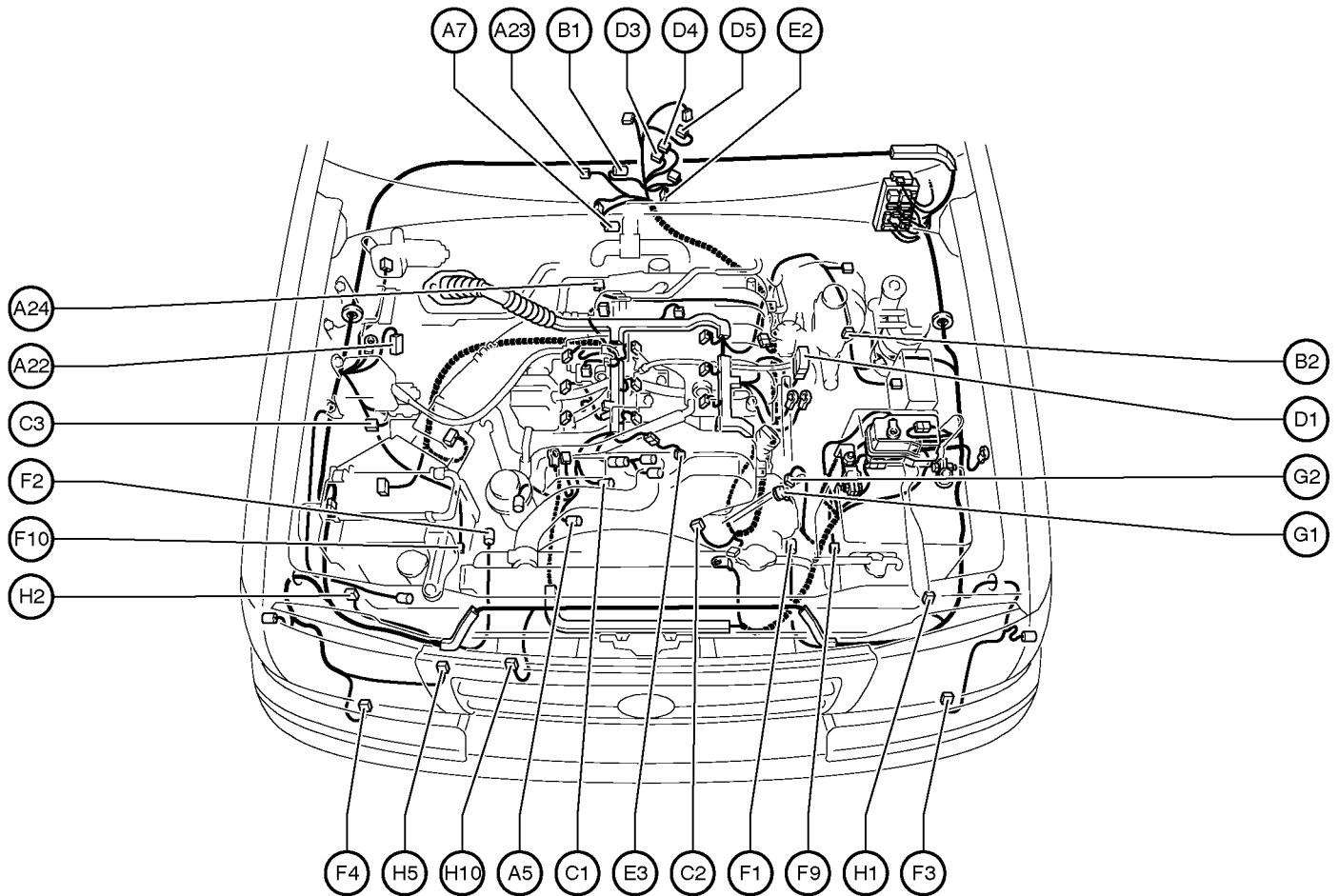

- | | |
|--|---|
| A 5 A/C Magnetic Clutch | E 2 Electronically Controlled Transmission Solenoid |
| A 7 A/T Oil Temp. Sensor | E 3 Engine Coolant Temp. Sensor |
| A22 ABS Actuator with ECU | F 1 Front ABS Speed Sensor LH |
| A23 Air Fuel Ratio Sensor (Bank 1 Sensor 1) | F 2 Front ABS Speed Sensor RH |
| A24 ADD Actuator | F 3 Front Turn Signal Light LH |
| B 1 Back-Up Light SW | F 4 Front Turn Signal Light RH |
| B 2 Brake Fluid Level Warning SW | F 9 Front Airbag Sensor LH |
| C 1 Camshaft Position Sensor | F 10 Front Airbag Sensor RH |
| C 2 Crankshaft Position Sensor | G 1 Generator |
| C 3 Cruise Control Actuator | G 2 Generator |
| D 1 Data Link Connector 1 | H 1 Headlight LH |
| D 3 Detection SW (Transfer L4 Position) | H 2 Headlight RH |
| D 4 Detection SW (Transfer Neutral Position) | H 5 Horn (Low) |
| D 5 Detection SW (Transfer 4WD Position) | H10 Horn (High) |

Position of Parts in Engine Compartment

[5VZ-FE]

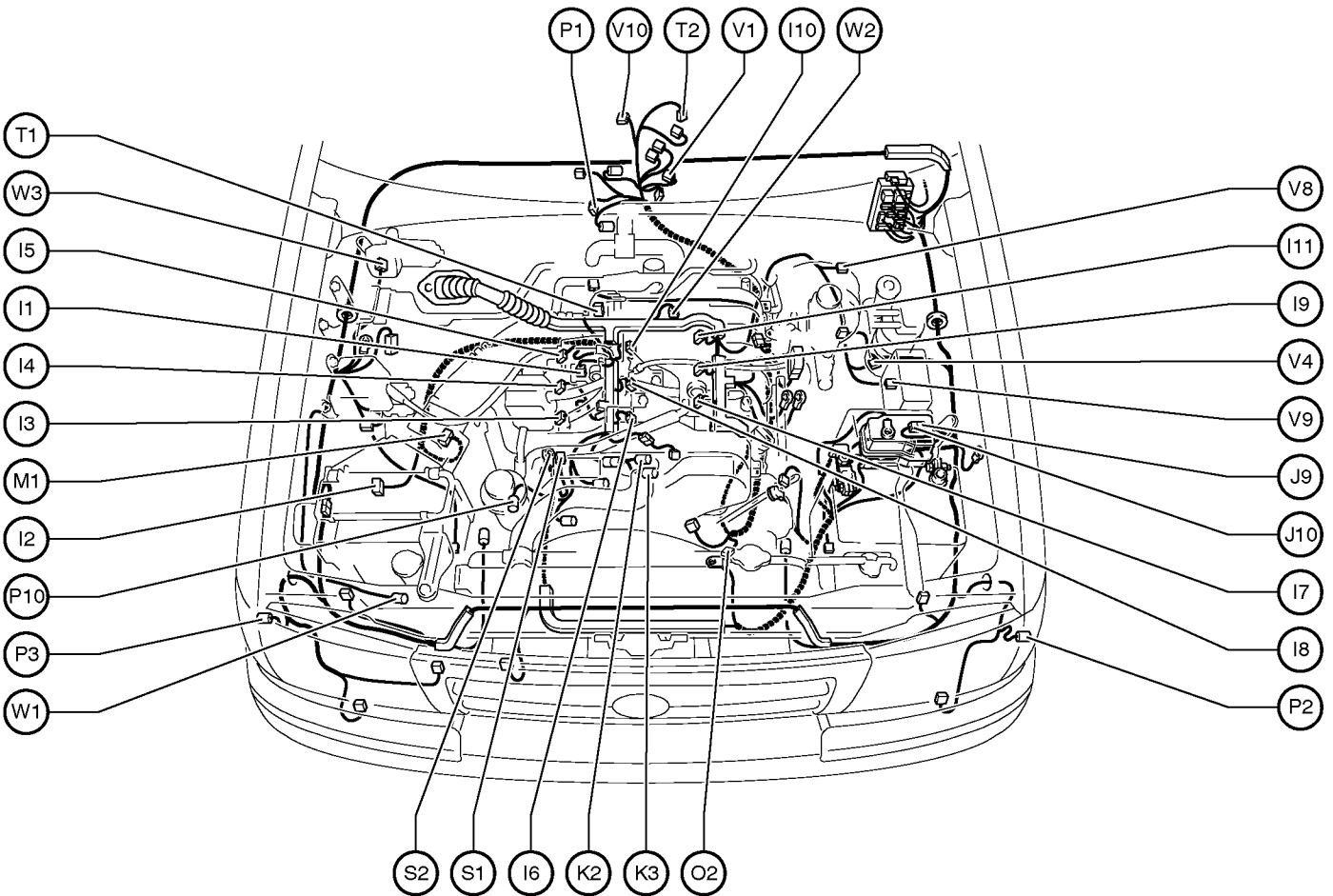

I 1 Idle Air Control Valve
 I 2 Igniter
 I 3 Ignition Coil No.1
 I 4 Ignition Coil No.2
 I 5 Ignition Coil No.3
 I 6 Injector No.1
 I 7 Injector No.2
 I 8 Injector No.3
 I 9 Injector No.4
 I 10 Injector No.5
 I 11 Injector No.6

J 9 Junction Connector
 J 10 Junction Connector

K 2 Knock Sensor 1
 K 3 Knock Sensor 2

M 1 Mass Air Flow Meter

O 2 Oil Pressure SW

P 1 Park/Neutral Position SW
 P 2 Parking Light LH
 P 3 Parking Light RH
 P10 Power Steering Oil Pressure SW

S 1 Starter
 S 2 Starter

T 1 Throttle Position Sensor
 T 2 2-4 Select Motor

V 1 Vehicle Speed Sensor
 (Electronically Controlled Transmission)
 V 4 VSV (EVAP)
 V 8 Vapor Pressure Sensor
 V 9 VSV (Vapor Pressure Sensor)
 V10 Vehicle Speed Sensor

W 1 Washer Motor and Washer Level Sensor
 (Cold Area Spec.) or Washer Motor
 (Except Cold Area Spec.)

W 2 Water Temp. Sender
 W 3 Wiper Motor

G ELECTRICAL WIRING ROUTING

Position of Parts in Engine Compartment

[3RZ-FE, 2RZ-FE]

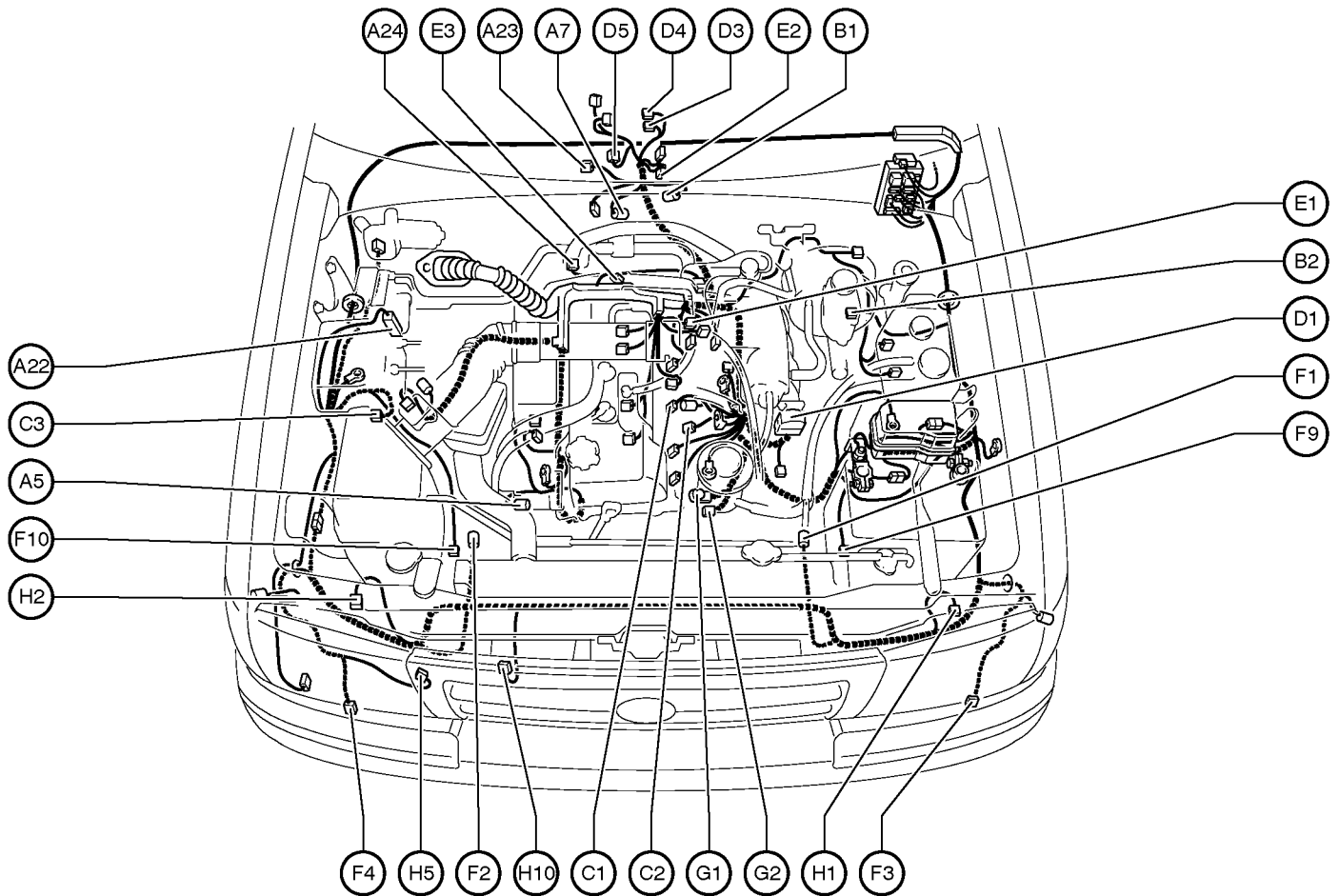

- | | |
|--|---|
| A 5 A/C Magnetic Clutch | E 1 EGR Gas Temp. Sensor |
| A 7 A/T Oil Temp. Sensor | E 2 Electronically Controlled Transmission Solenoid |
| A22 ABS Actuator with ECU | E 3 Engine Coolant Temp. Sensor |
| A23 Air Fuel Ratio Sensor (Bank 1 Sensor 1) | F 1 Front ABS Speed Sensor LH |
| A24 ADD Actuator | F 2 Front ABS Speed Sensor RH |
| B 1 Back-Up Light SW | F 3 Front Turn Signal Light LH |
| B 2 Brake Fluid Level Warning SW | F 4 Front Turn Signal Light RH |
| C 1 Camshaft Position Sensor | F 9 Front Airbag Sensor LH |
| C 2 Crankshaft Position Sensor | F 10 Front Airbag Sensor RH |
| C 3 Cruise Control Actuator | G 1 Generator |
| D 1 Data Link Connector 1 | G 2 Generator |
| D 3 Detection SW (Transfer L4 Position) | H 1 Headlight LH |
| D 4 Detection SW (Transfer Neutral Position) | H 2 Headlight RH |
| D 5 Detection SW (Transfer 4WD Position) | H 5 Horn (Low) |
| | H10 Horn (High) |

Position of Parts in Engine Compartment

[3RZ-FE, 2RZ-FE]

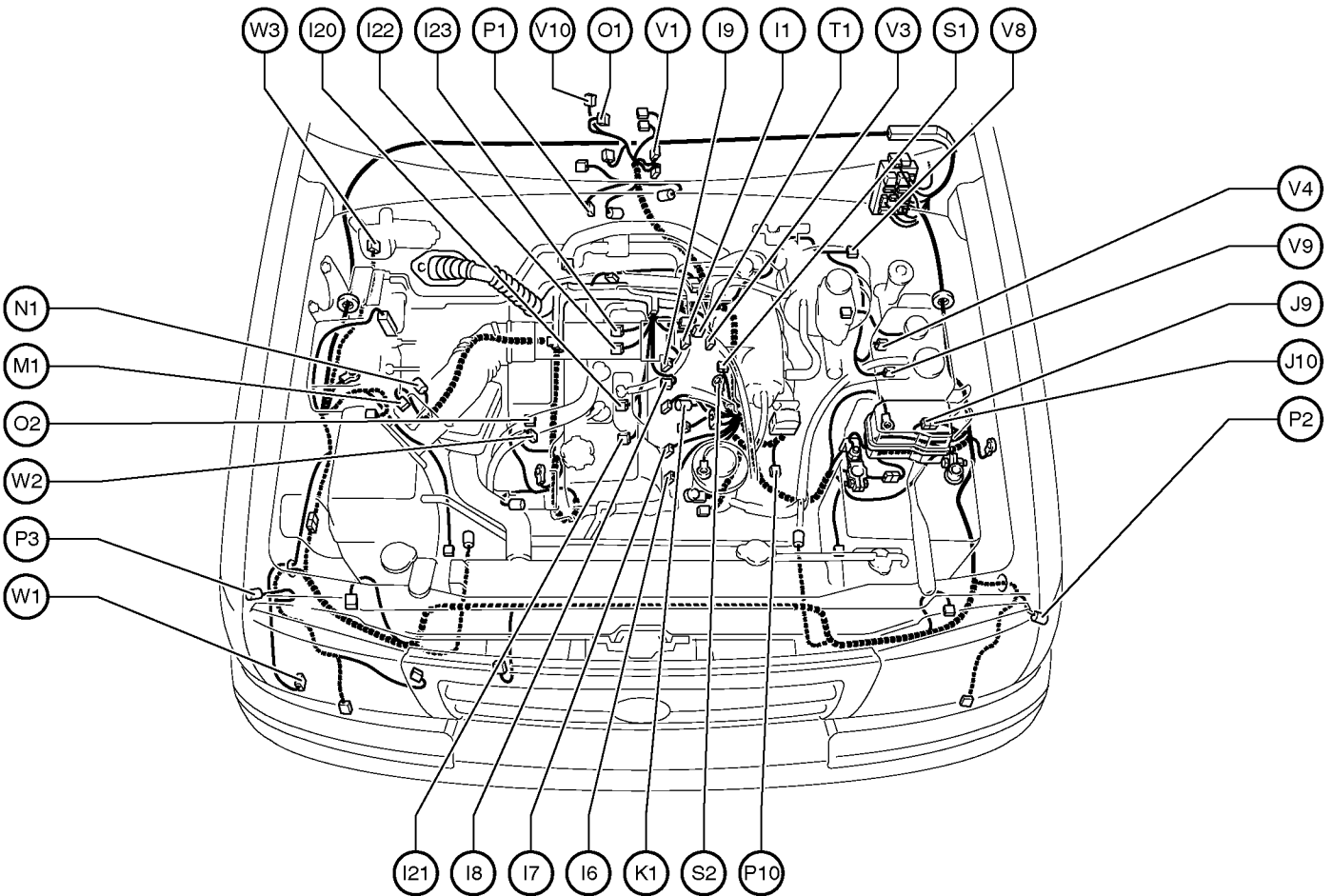

I 1 Idle Air Control Valve
 I 6 Injector No.1
 I 7 Injector No.2
 I 8 Injector No.3
 I 9 Injector No.4
 I 20 Ignition Coil and Igniter No.1
 I 21 Ignition Coil and Igniter No.2
 I 22 Ignition Coil and Igniter No.3
 I 23 Ignition Coil and Igniter No.4

J 9 Junction Connector
 J 10 Junction Connector

K 1 Knock Sensor

M 1 Mass Air Flow Meter

N 1 Noise Filter (Ignition System)

O 1 O/D Solenoid
 O 2 Oil Pressure SW

P 1 Park/Neutral Position SW
 P 2 Parking Light LH
 P 3 Parking Light RH
 P10 Power Steering Oil Pressure SW

S 1 Starter
 S 2 Starter

T 1 Throttle Position Sensor

V 1 Vehicle Speed Sensor
(Electronically Controlled Transmission)

V 3 VSV (EGR)

V 4 VSV (EVAP)

V 8 Vapor Pressure Sensor

V 9 VSV (Vapor Pressure Sensor)

V10 Vehicle Speed Sensor

W 1 Washer Motor and Washer Level Sensor
 (Cold Area Spec.) or Washer Motor
 (Except Cold Area Spec.)

W 2 Water Temp. Sender

W 3 Wiper Motor

G ELECTRICAL WIRING ROUTING

Position of Parts in Instrument Panel

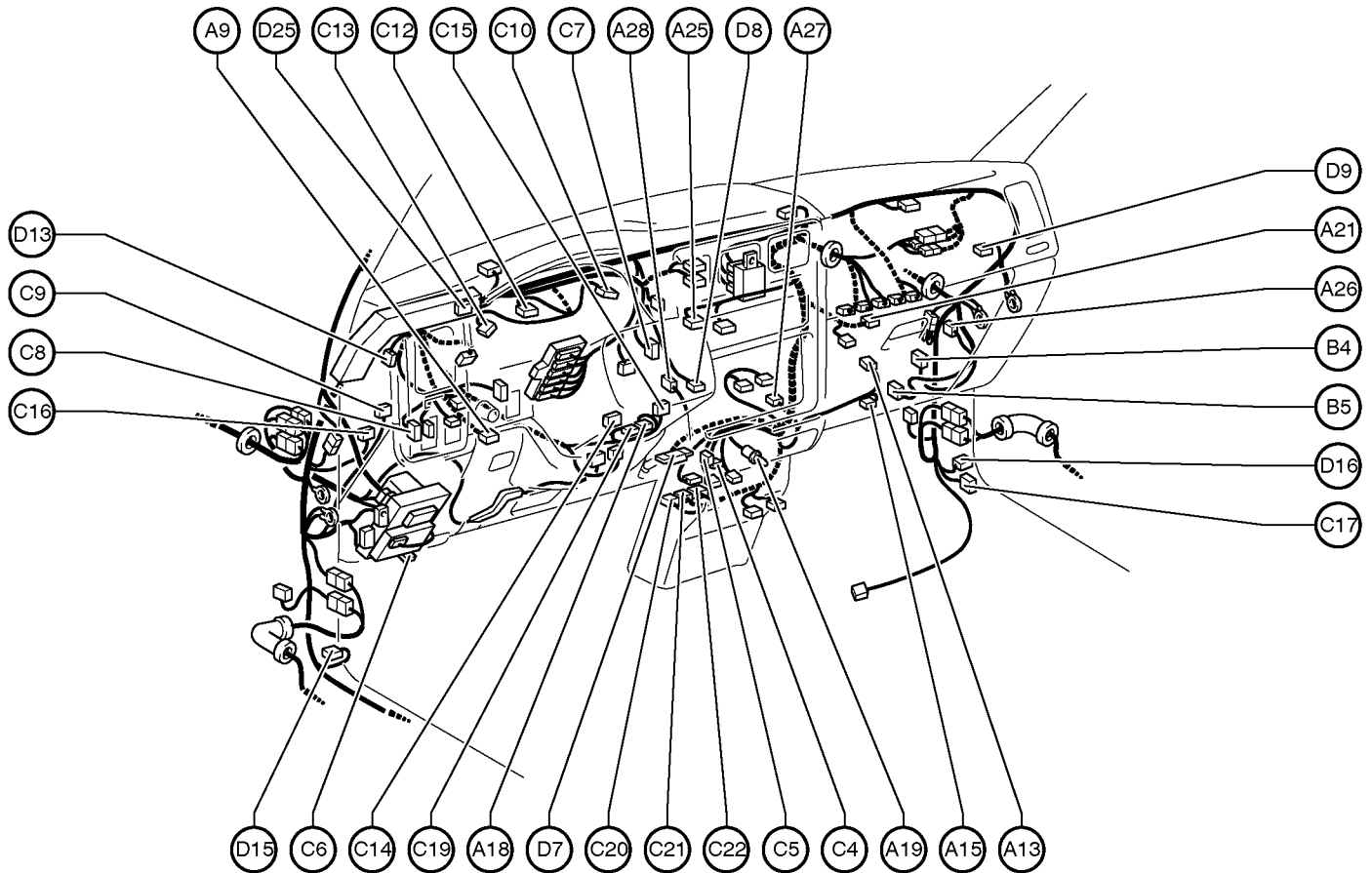

- | | |
|--|--|
| A 9 ABS Deceleration Sensor | C10 Combination Meter |
| A13 A/C Dual Pressure SW | C12 Combination Meter |
| A15 A/C Thermistor | C13 Combination Meter |
| A18 Airbag Squib (Steering Wheel Pad) | C14 Combination SW |
| A19 Ashtray Illumination | C15 Combination SW |
| A21 Airbag Squib (Front Passenger Airbag Assembly) | C16 Cruise Control Clutch SW |
| A25 A/C Control Assembly | C17 Cruise Control ECU |
| A26 Air Inlet Control Servo Motor | C19 Combination SW |
| A27 Air Mix Control Servo Motor | C20 Center Airbag Sensor Assembly |
| A28 Air Vent Mode Control Servo Motor | C21 Center Airbag Sensor Assembly |
| | C22 Center Airbag Sensor Assembly |
| B 4 Blower Motor | D 7 Data Link Connector 3 |
| B 5 Blower Resistor | D 8 Daytime Running Light Relay (Main) |
| C 4 Cigarette Lighter | D 9 Daytime Running Light Relay No.4 |
| C 5 Cigarette Lighter Illumination | D13 Diode (Daytime Running Light System) |
| C 6 Circuit Opening Relay | D15 Door Courtesy SW Front LH |
| C 7 Clock | D16 Door Courtesy SW Front RH |
| C 8 Clutch Start Cancel SW | D25 Diode (A/T) |
| C 9 Clutch Start SW | |

Position of Parts in Instrument Panel

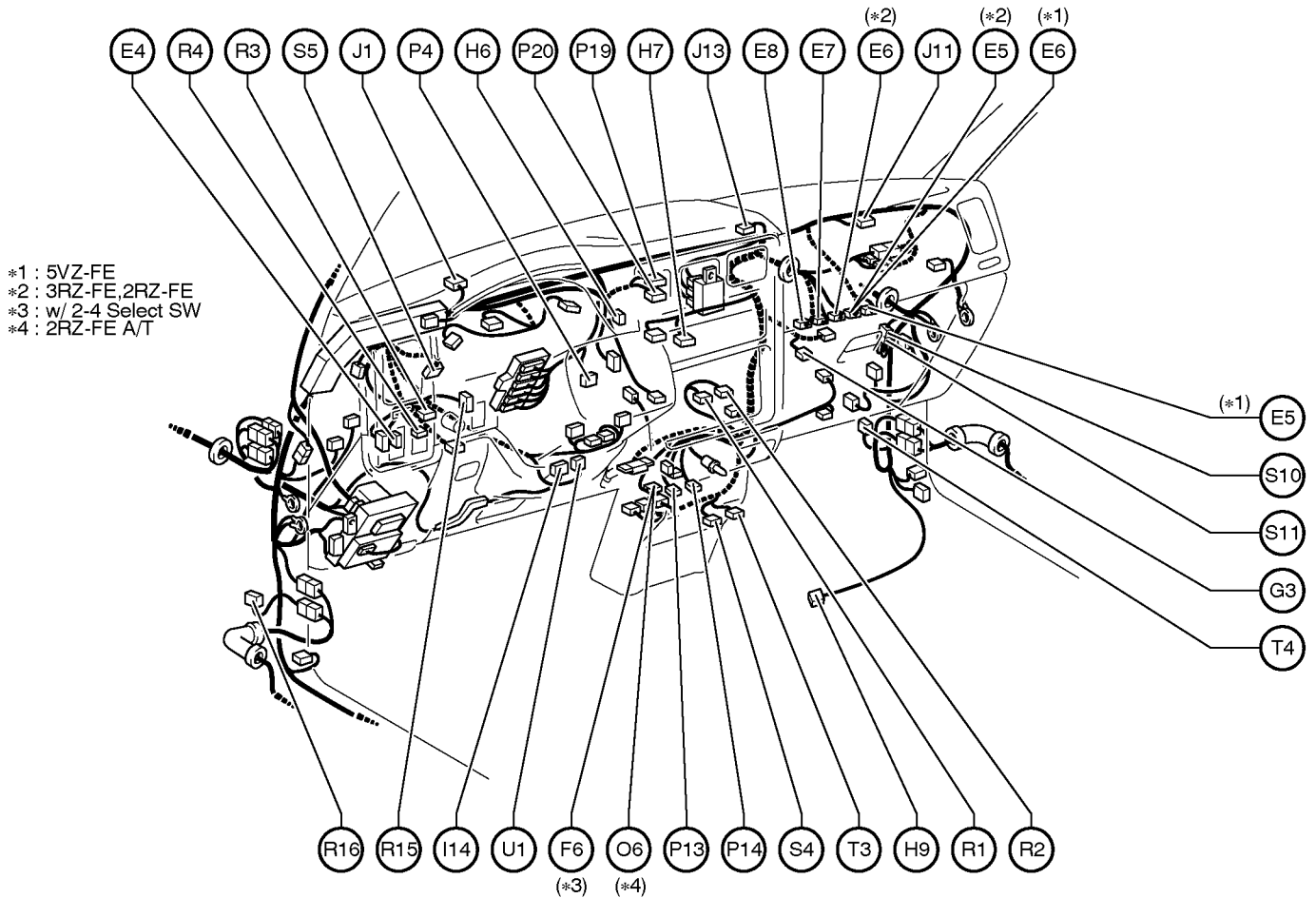

E 4 Electronically Controlled Transmission Pattern Select SW	P 4 Parking Brake SW
E 5 Engine Control Module	P 13 Power Outlet
E 6 Engine Control Module	P 14 Power Outlet
E 7 Engine Control Module	P 19 Passenger Airbag Manual On/Off Indicator
E 8 Engine Control Module	P 20 Passenger Airbag Manual On/Off SW
F 6 4WD ECU	R 1 Radio and Player
G 3 Glove Box Light	R 2 Radio and Player
H 6 Hazard SW	R 3 Rheostat
H 7 Heater Blower SW	R 4 Rheostat
H 9 Heated Oxygen Sensor (Bank 1 Sensor 2)	R 15 Rear Diff. Lock SW
I 14 Ignition SW	R 16 Rear Diff. Lock ECU
J 1 Junction Connector	S 4 Shift Lock Control Relay and O/D Main SW
J 11 Junction Connector	S 5 Stop Light SW
J 13 Junction Connector	S 10 Short Connector (ADD)
O 6 O/D ECU	S 11 Short Connector (ADD)
	T 3 2-4 Select SW
	T 4 Transmission Control Relay
	U 1 Unlock Warning SW and Key Interlock Solenoid

G ELECTRICAL WIRING ROUTING

Position of Parts in Body

[Double Cab]

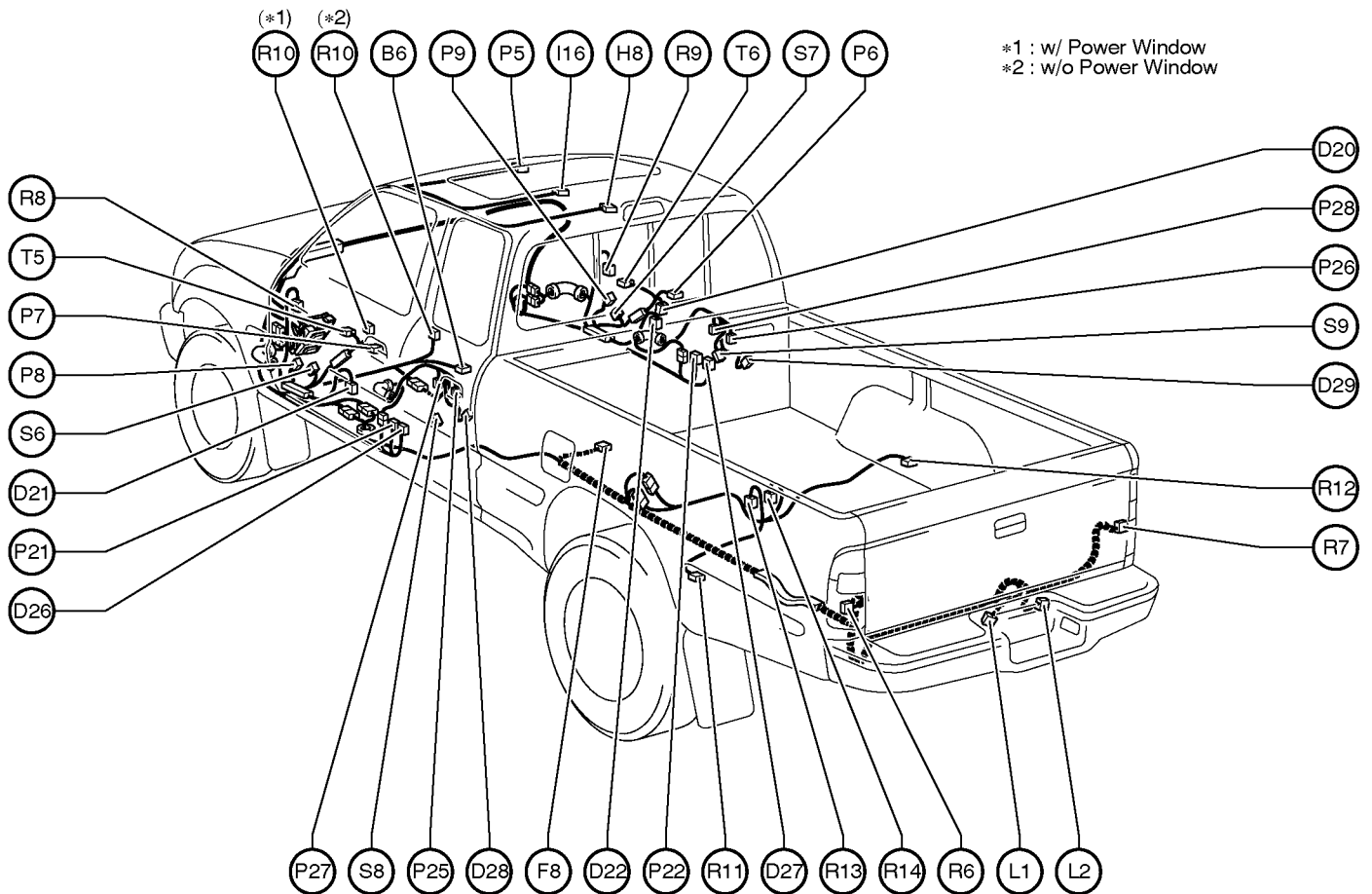

B 6 Buckle SW LH

- D20 Door Lock Control SW RH
- D21 Door Lock Motor, Door Unlock Detection SW and Door Key Lock and Unlock SW Front LH
- D22 Door Lock Motor, Door Unlock Detection SW and Door Key Lock and Unlock SW Front RH
- D26 Door Courtesy SW Rear LH
- D27 Door Courtesy SW Rear RH
- D28 Door Lock Motor Rear LH
- D29 Door Lock Motor Rear RH

F 8 Fuel Pump and Sender

H 8 High Mounted Stop Light

I 16 Interior Light

- L 1 License Plate Light LH
- L 2 License Plate Light RH

- P 5 Personal Light
- P 6 Power Window Control SW Front RH
- P 7 Power Window Master SW and Door Lock Control SW LH
- P 8 Power Window Motor Front LH

- P 9 Power Window Motor Front RH
- P21 Pretensioner LH
- P22 Pretensioner RH
- P25 Power Window Control SW Rear LH
- P26 Power Window Control SW Rear RH
- P27 Power Window Motor Rear LH
- P28 Power Window Motor Rear RH

- R 6 Rear Combination Light LH
- R 7 Rear Combination Light RH
- R 8 Remote Control Mirror LH
- R 9 Remote Control Mirror RH
- R10 Remote Control Mirror SW
- R11 Rear ABS Speed Sensor LH
- R12 Rear ABS Speed Sensor RH
- R13 Rear Diff. Lock Detection SW
- R14 Rear Diff. Lock Motor

- S 6 Speaker (Front Door LH)
- S 7 Speaker (Front Door RH)
- S 8 Speaker (Rear LH)
- S 9 Speaker (Rear RH)

- T 5 Tweeter LH
- T 6 Tweeter RH

Position of Parts in Body

[Except Double Cab]

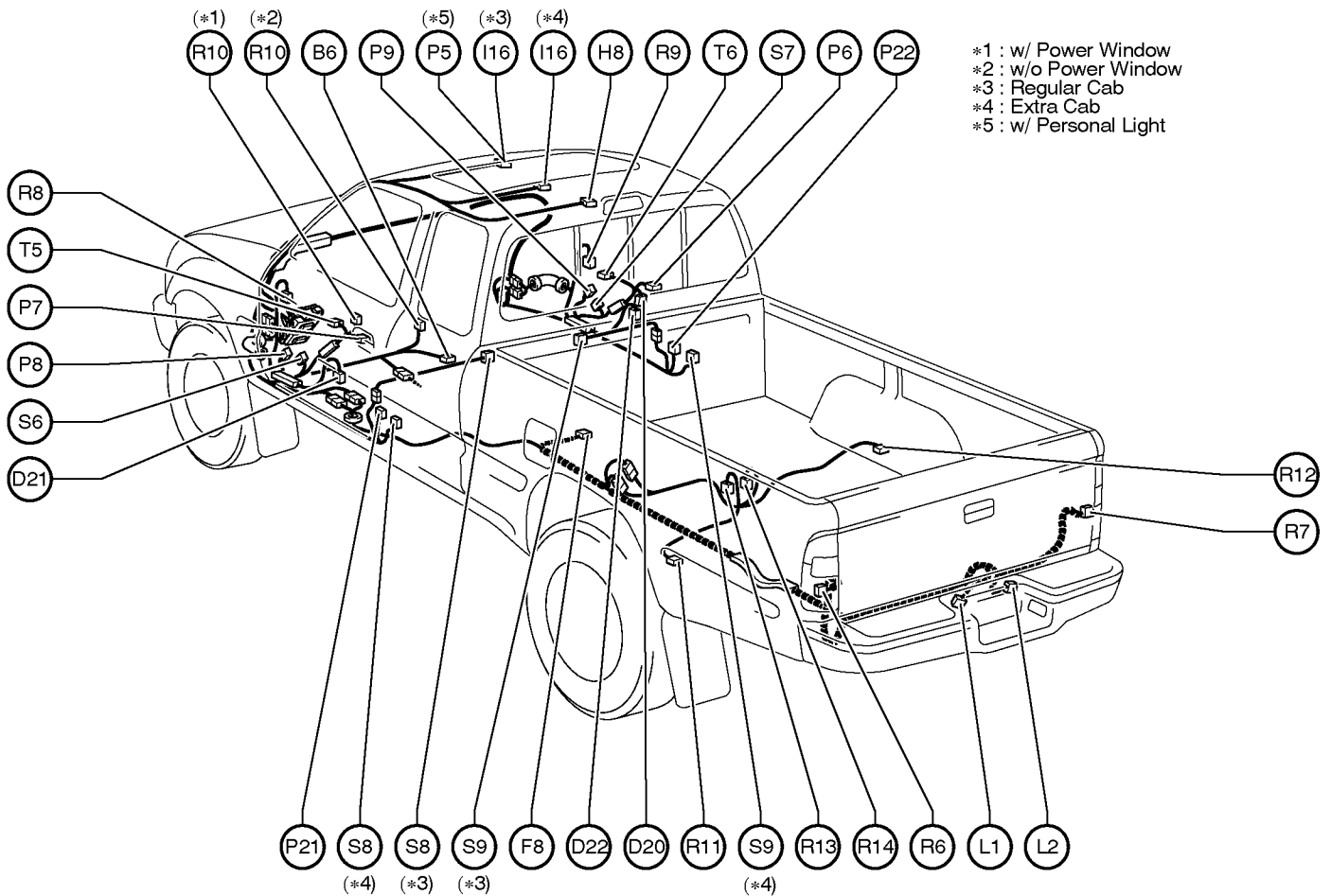

- *1 : w/ Power Window
- *2 : w/o Power Window
- *3 : Regular Cab
- *4 : Extra Cab
- *5 : w/ Personal Light

B 6 Buckle SW LH

D20 Door Lock Control SW RH

D21 Door Lock Motor, Door Unlock Detection SW and Door Key Lock and Unlock SW Front LH

D22 Door Lock Motor, Door Unlock Detection SW and Door Key Lock and Unlock SW Front RH

F 8 Fuel Pump and Sender

H 8 High Mounted Stop Light

I 16 Interior Light

L 1 License Plate Light LH

L 2 License Plate Light RH

P 5 Personal Light

P 6 Power Window Control SW Front RH

P 7 Power Window Master SW and Door Lock Control SW LH

P 8 Power Window Motor Front LH

P 9 Power Window Motor Front RH

P21 Pretensioner LH

P22 Pretensioner RH

R 6 Rear Combination Light LH

R 7 Rear Combination Light RH

R 8 Remote Control Mirror LH

R 9 Remote Control Mirror RH

R10 Remote Control Mirror SW

R11 Rear ABS Speed Sensor LH

R12 Rear ABS Speed Sensor RH

R13 Rear Diff. Lock Detection SW

R14 Rear Diff. Lock Motor

S 6 Speaker (Front Door LH)

S 7 Speaker (Front Door RH)

S 8 Speaker (Rear LH)

S 9 Speaker (Rear RH)

T 5 Tweeter LH

T 6 Tweeter RH

G ELECTRICAL WIRING ROUTING

Position of Parts in Seat

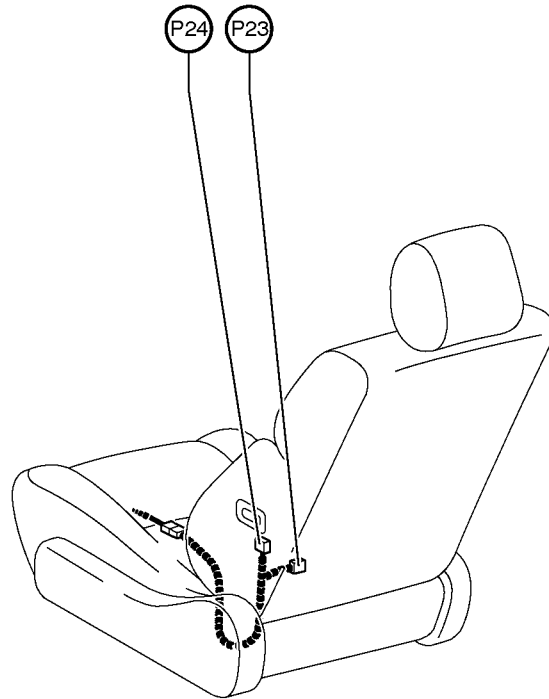

- P23 Power Seat Motor (Lumbar Support)
- P24 Power Seat SW (Lumbar Support)

